



PLAIN SHANK
GLATTER ZYLINDERSCHAFT

FLAT SHANK
SEITLICHEN MITNAHMEFLÄCHEN

CARBIDE, 4 FLUTE MULTIPLE HELIX LONG LENGTH VOLLHARTMETALL, 4 SCHNEIDEN LANG

- ▶ Special flute geometry and multiple helix eliminate vibrations
- ▶ Designed to machine mild steels, cast irons, tool steels, and low hardened steels up to HRc 40.
- ▶ Excellent work piece finishes.
- ▶ Higher speeds, deeper cuts, and higher metal removal rates.

- ▶ Besondere Nutenform und variable Drallsteigung verhindern Vibrationen.
- ▶ Für die Bearbeitung von Baustahl, Guss, Werkzeugstahl und niedrig legierten Stählen bis HRc40.
- ▶ Ausgezeichnete Werkstückoberfläche.
- ▶ Höhere Schnittgeschwindigkeit, tieferer Schnitt und größeres Entspannungsvolumen.

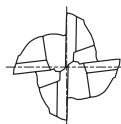

Unit : mm

EDP No.		Mill Diameter	Shank Diameter	Length of Cut	Overall Length
PLAIN	FLAT				
EMD38030	EMD39030	3.0	6	8	57
EMD38040	EMD39040	4.0	6	11	57
EMD38050	EMD39050	5.0	6	13	57
EMD38060	EMD39060	6.0	6	13	57
EMD38080	EMD39080	8.0	8	19	63
EMD38100	EMD39100	10.0	10	22	72
EMD38120	EMD39120	12.0	12	26	83
EMD38140	EMD39140	14.0	14	26	83
EMD38160	EMD39160	16.0	16	32	92
EMD38180	EMD39180	18.0	18	32	92
EMD38200	EMD39200	20.0	20	38	104
EMD38250	EMD39250	25.0	25	38	104

Mill Dia. Tolerance(mm)	Shank Dia. Tolerance
0~-0.03	h6

Carbon Steels	Alloy Steels	Prehardened Steels	Hardened Steels		High Hardened Steels	Copper	Graphite	Cast Iron	Aluminum	Stainless Steels	Titanium	Inconel
~HB225	HB225~325	HRc30~40	HRc40~45	HRc45~55	HRc55~70							
○	○	○	○	○				○				

◎ : Excellent ○ : Good



**V7 Mill STEEL
END MILLS**

**RECOMMENDED CUTTING CONDITIONS
EMPFOHLENE SCHNEIDKONDITIONEN**

**CARBIDE, 4 FLUTE
VOLLHARTMETALL, 4 SCHNEIDEN**

EMD42, EMD43, EMD44, EMD45, EMD38, EMD39, EMD40, EMD41, EMD46, EMD47, EMD48, EMD49 SERIES

MATERIAL	ALLOY STEELS CAST IRON		ALLOY STEELS CAST IRON	
HARDNESS	~ HB 300		HB 300 ~ HB 380	
STRENGTH	~ 1000N/mm ²		1000 ~ 1300N/mm ²	
DIAMETER	RPM	FEED	RPM	FEED
3.0	13475	275	9430	190
4.0	10105	330	7070	230
5.0	8085	370	5660	260
6.0	6735	435	4715	305
8.0	5050	555	3535	385
10.0	4455	690	3115	480
12.0	3710	695	2600	485
14.0	3180	620	2225	435
16.0	2785	590	1950	410
18.0	2475	585	1730	410
20.0	2225	580	1560	405
25.0	1780	450	1245	315

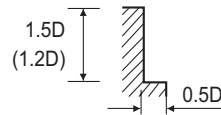
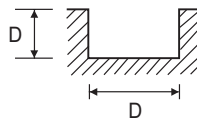

* () : Short length Type

RPM = rev./min.
FEED = mm/min.