



DIN 69871

## Weldon Coolant Grooves / SK40 AD/B



### Verlinkung Zubehör

01020, 01032B,

### Verwendung

For milling-tools with cylindrical shaft type Weldon DIN 1835 Form B. Suitable for internal coolant flow Form AD/B = either central or over collar. Coolant channels in the collar are closed by a plastic dowel which can be removed if necessary. Please don't re-use the removed plastic dowels.

### Lieferumfang

with 1 clamping screw, from Dia 25mm with 2 screws

### Werkstoff

Alloyed case-hardened steel with a tensile strength of min. 800 N/mm<sup>2</sup>. Carbonized according to Vickers min. 630 HV (min. 56 HRC) Shank and cylindrical surface are grinded. Pre-balanced G6,3 12.000 rpm

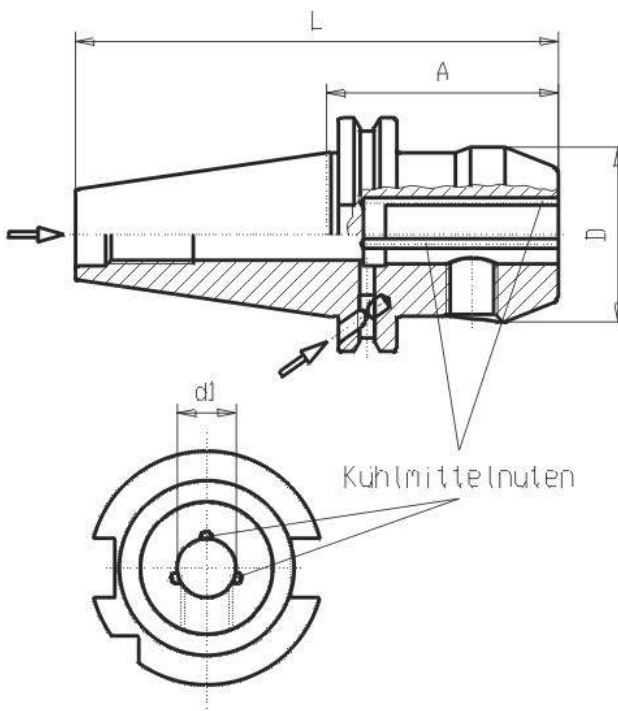

Article-Nr.	SK	d1	A	Form	L	D	Kühlmitteleuten
G323D40x 6x 50	40	6	50	AD/B	119	25	2
G323D40x 8x 50	40	8	50	AD/B	119	28	2
G323D40x10x 50	40	10	50	AD/B	119	35	2
G323D40x12x 50	40	12	50	AD/B	119	42	2
G323D40x14x 50	40	14	50	AD/B	119	42	2
G323D40x16x 63	40	16	63	AD/B	132	48	2
G323D40x18x 63	40	18	63	AD/B	132	48	2
G323D40x20x 63	40	20	63	AD/B	132	52	2
G323D40x22x 63	40	22	63	AD/B	132	52	2
G323D40x25x100	40	25	100	AD/B	169	63	2



DIN 69871

## Weldon Coolant Grooves / SK50 AD/B



### Verlinkung Zubehör

01020, 01032B,

### Verwendung

For milling-tools with cylindrical shaft type Weldon DIN 1835 Form B. Suitable for internal coolant flow Form AD/B = either central or over collar. Coolant channels in the collar are closed by a plastic dowel which can be removed if necessary. Please don't re-use the removed plastic dowels.

### Lieferumfang

with 1 clamping screw, from Dia 25mm with 2 screws

### Werkstoff

Alloyed case-hardened steel with a tensile strength of min. 800 N/mm<sup>2</sup>. Carbonized according to Vickers min. 630 HV (min. 56 HRC) Shank and cylindrical surface are grinded.

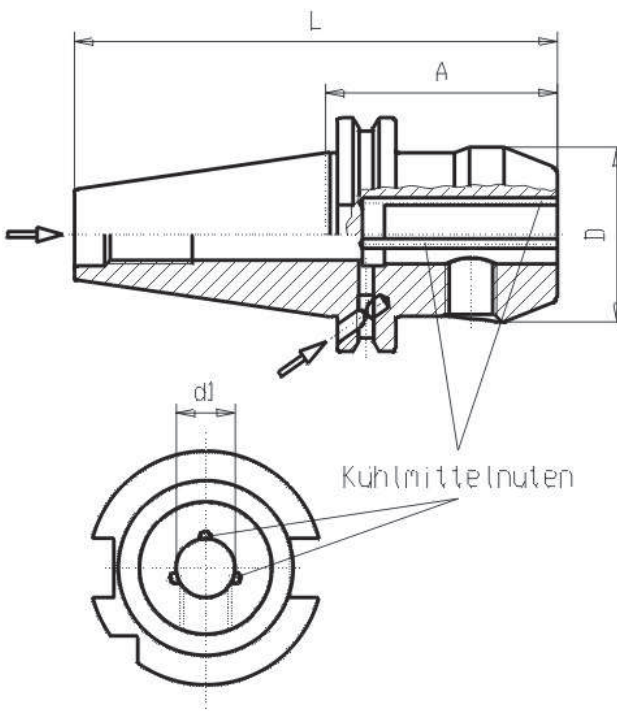

Article-Nr.	SK	d1	A	Form	L	D	Kühlmitteleuten
G323D50x 6x 63	50	6	63	AD/B	165	25	2
G323D50x 8x 63	50	8	63	AD/B	165	28	2
G323D50x10x 63	50	10	63	AD/B	165	35	2
G323D50x12x 63	50	12	63	AD/B	165	42	2
G323D50x14x 63	50	14	63	AD/B	165	42	2
G323D50x16x 63	50	16	63	AD/B	165	48	2
G323D50x18x 63	50	18	63	AD/B	165	48	2
G323D50x20x 63	50	20	63	AD/B	165	52	2
G323D50x22x 63	50	22	63	AD/B	165	52	2
G323D50x25x 80	50	25	80	AD/B	182	63	2
G323D50x32x100	50	32	100	AD/B	202	70	2
G323D50x40x100	50	40	100	AD/B	202	90	2