

Simple Indexing Spacer



CC-12
BIG HOLE DESIGN



CC-8



- The center through hole is big to be suitable for the large and long workpiece.
- Hardened and ground 24 position master plate, can index the special angle of 15 with excellent accuracy.
- CS-Type can be used with 2 pcs type 3-Jaw Chuck. Especially, it does similar work. as rotary table when it match with face plate.
- Rapid indexing and easy operation. It's a sharp equipment for mass-production.
- Simple index include 3-jaw chuck, Masking Plates 2, 3, 4, 6, 8, 12
- Used the key guide block, the center can be corrected quickly and accurately.
- CC-6 WITH VSK-6A CHUCK
CC-8 WITH VSK-8A CHUCK
CC-12 WITH VSK-12 CHUCK

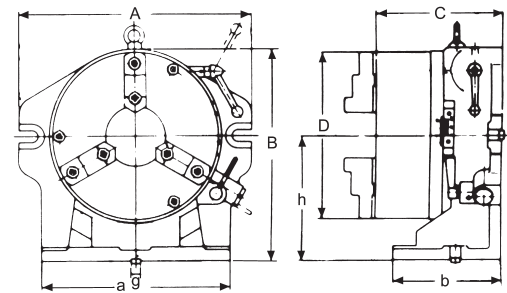

Special Accessories



STANDARDS OF ACCURACY for Simple Index for Super-Dex.		
NO.	Testing Objective	Tolerances Unit: inches Permitted Max.
1	Parallelism of table surface to base per 12"	.0006
2	True running of axial movement of table surface	.0006
3	True running of center boss	.0004
4	Squareness of base to angle face per 12"	.0008
5	True running of chuck center	.0012
6	Dividing accuracy individual spacing error	45"

Specifications

Unit:mm

ORDER NO.	Dividual number	A	B	C	D	a	b	h	Inner jaw	Guide black	Outer jaw	Diameter of hole (turret)	Diameter of hole (chuck)	Gross weight kg	Meas. CFT	CODE NO.
										g						
CC-6	2, 3, 4, 6, 8, 12, 24	260	218	156.2	167	220	130	123	4~42	16	10~156	44	44	(C)29.5	0.9	1001-062
CC-8	2, 3, 4, 6, 8, 12, 16, 24, 48	312	257	173.3	200	258	148	155	4~62	16	10~180	63	58	(C)51.5	1.3	1001-063
CC-12	2, 3, 4, 6, 8, 12, 16, 24, 48	433.2	391	232.5	310	353.8	198.3	228	5~108	16	15~265	106	105	(W)90.7	3.6	1001-066