

DIN 69871 - Tapping Chuck - SK30 with compensation



https://www.kfh-hermann.de/shop/product_info.php?products_id=76&XTCsid=n7eemf1jolajl8itk84fees403

Illustration



(https://www.kfh-hermann.de/shop/shop/images/product_images/original_images/bilder_B317.jpg?XTCsid=n7eemf1jolajl8itk84fees403)

Drawing

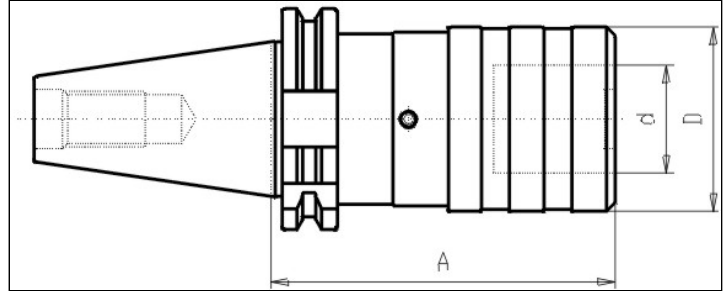

(https://www.kfh-hermann.de/shop/shop/images/product_images/original_images/skizzen_Z317mb.jp?XTCsid=n7eemf1jolajl8itk84fees403)

Technical information

Usage:	For fixing bushes for tapping chucks see Group 013. The torque of chamfer start can be adjusted mechanical with an hexagon socket screw. With compensation on press and pull
Customs tariff code:	84 661 02 0

Variants

Product No.	SK	Size	Thread	A	Form	d.	D	weight in kg	Stock 12.02, 08:14	Net-price
G317 30x 1x 60	30	1	M3-M12	60	A	19	38	0,65	2	Please start an inquiry
G317 30x 2x101	30	2	M8-M20	101	A	31	55	1,25	2	Please start an inquiry

Stock data from 2024-02-12 08:14:41

Kontakt

KARL HERMANN GmbH | Varnbülerstrasse 10 - 12 | D - 71229 Leonberg | | Tel.: +49 (0)7152 / 93992-0 | Fax: +49 (0)7152 / 93992-4 | E-Mail: verkauf@kfh-hermann.de | Internet: <http://www.kfh-hermann.de>

2024-02-13 10:55:31, https://www.kfh-hermann.de/shop/product_info.php?products_id=76&XTCsid=n7eemf1jolajl8itk84fees403