

Pull Studs - Special Pull studs - Tangs to screw in

https://www.kfh-hermann.de/shop/product_info.php?products_id=384&XTCsid=n7eemf1jolajl8itk84fees403



Illustration



(https://www.kfh-hermann.de/shop/shop/images/product_images/original_images/bilder_B052.jpg?XTCsid=n7eemf1jolajl8itk84fees403)

Drawing

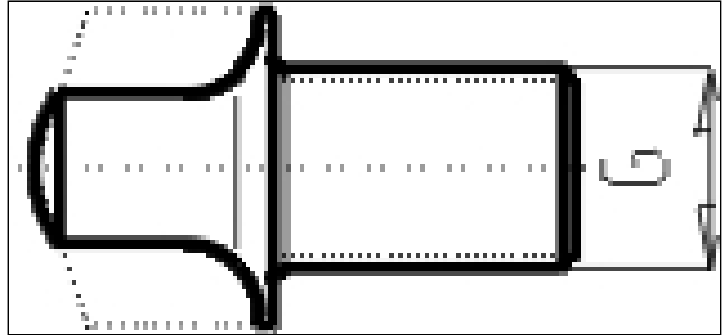

(https://www.kfh-hermann.de/shop/shop/images/product_images/original_images/skizzen_Z052mb.jp?XTCsid=n7eemf1jolajl8itk84fees403)

Technical information

Usage:	to be screwed in toolholders with morse-taper and thread
Customs tariff code:	73 181 59 0

Variants

Product No.	MT	Thread	weight in kg	Stock 12.02, 08:14	Net-price
G052 1	1	M 6	0,005	2	Please start an inquiry
G052 2	2	M 10	0,016	10	Please start an inquiry
G052 3	3	M 12	0,03	9	Please start an inquiry
G052 4	4	M 16	0,07	7	Please start an inquiry
G052 5	5	M 20	0,152	6	Please start an inquiry

Stock data from 2024-02-12 08:14:41

Kontakt

KARL HERMANN GmbH | Varnbülerstrasse 10 - 12 | D - 71229 Leonberg | | Tel.: +49 (0)7152 / 93992-0 | Fax: +49 (0)7152 / 93992-4 | E-Mail: verkauf@kfh-hermann.de | Internet: <http://www.kfh-hermann.de>

2024-02-13 12:50:46, https://www.kfh-hermann.de/shop/product_info.php?products_id=384&XTCsid=n7eemf1jolajl8itk84fees403